

Specifications

Structure	: Pile Foundation to a depth of 15 meters. RCC Framed Structure.
Floor Plan	: Stilt floor with 6 Covered car park, ample space for two wheeler Parking. Flats in I, II & III Floor with Lift and Staircase.
Main Door	: Wooden frame made of Teak and Teak Panel Door with Two side varnish finish, and fittings.
Internal Doors	: WPC frames & Flush door, Enamel Paint Finish, with Fittings and Locks.
Windows	: UPVC Openable windows with Glass shutters and grills.
Walls	: 9" Outer and 4.5" inner wall, with standard quality Bricks.
Paint	: Putty for internal walls with two coats of interior emulsion paint. One coat of white cement, two coats of exterior emulsion paint for external walls as per elevation design.
Flooring	: Joint free vetrified tiles of 4'x2' size of premium quality.
Kitchen	: Black granite platform with stainless steel sink and two taps for water including one for metro connection. Kitchen platform walls tiles upto 2' 0" height.
Bath room	: Walls with glazed ceramic tiles upto ceiling height and anti skid : Tiles for floors.
Toilets	: Floor mount EWC with flush tank for toilets
Wash basin and fittings	: Wash basin & closet with parryware make or equivalent.
Electrical	: Three phase EB connection, auto change over switch with circuit breaker. ELCB & MCB for each Distribution. Power Point for AC's in all bed Rooms and in Hall. Switches of reputed make .
Telephone	: Telephone points in hall and master bedroom.
Lift	: Premium make.
Extra Amenities	: Branded Generator, Solar Panel in the Rooftop CCTV Camera will be provided.

Mode Of Payment

Advance	10%
Land Registration	40%
Foundation Completion	15%
Roof Completion	15%
Inner Plastering Completion	10%
Outer Plastering Completion	05%
Handing Over The Key	05%

Note. Registration Charges, Covered Car park, GST, EB & CMWSSB connection charges will be extra.

We also help you in arranging Home loans from: SBI, AXIS, HDFC Bank Extra.

ARCHITECT
SEC Shanmugam Engineering Constructions
K.Mohan
Chennai - 600 024.

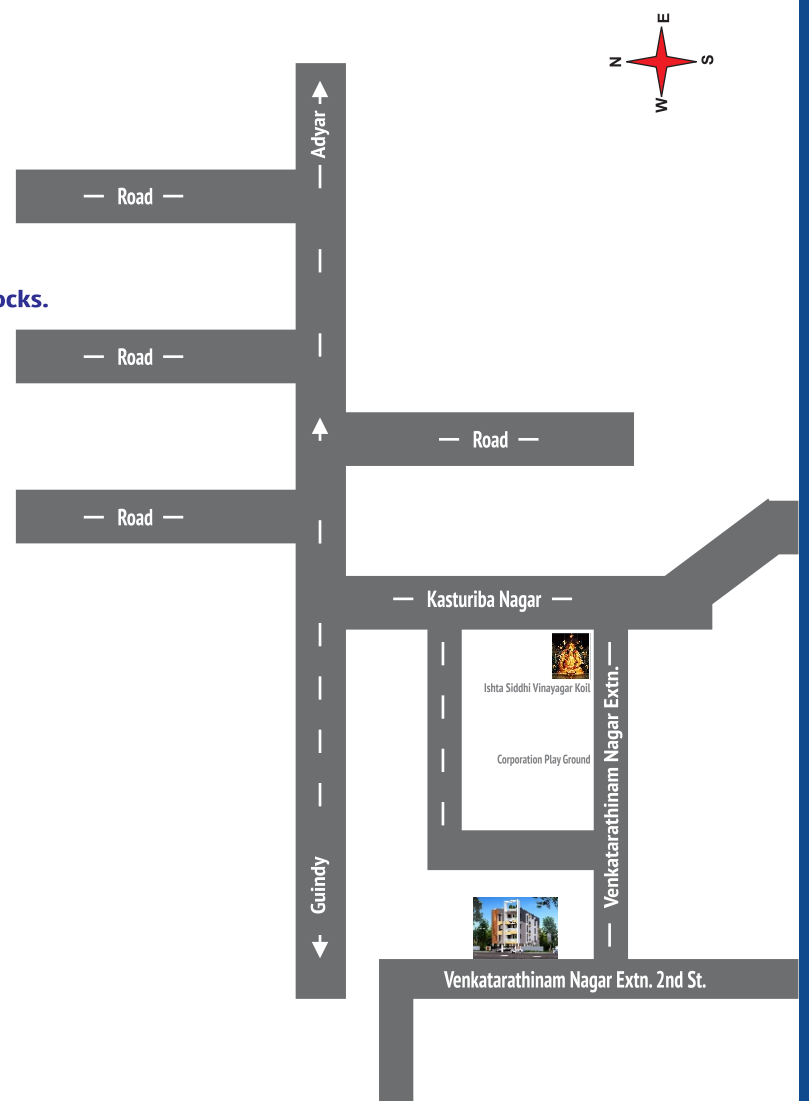



TYPICAL FLOOR PLAN

(I, II, III)

FLAT - F1 - S1 - T1 - 1549
 FLAT - F2 - S2 - T2 - 1370

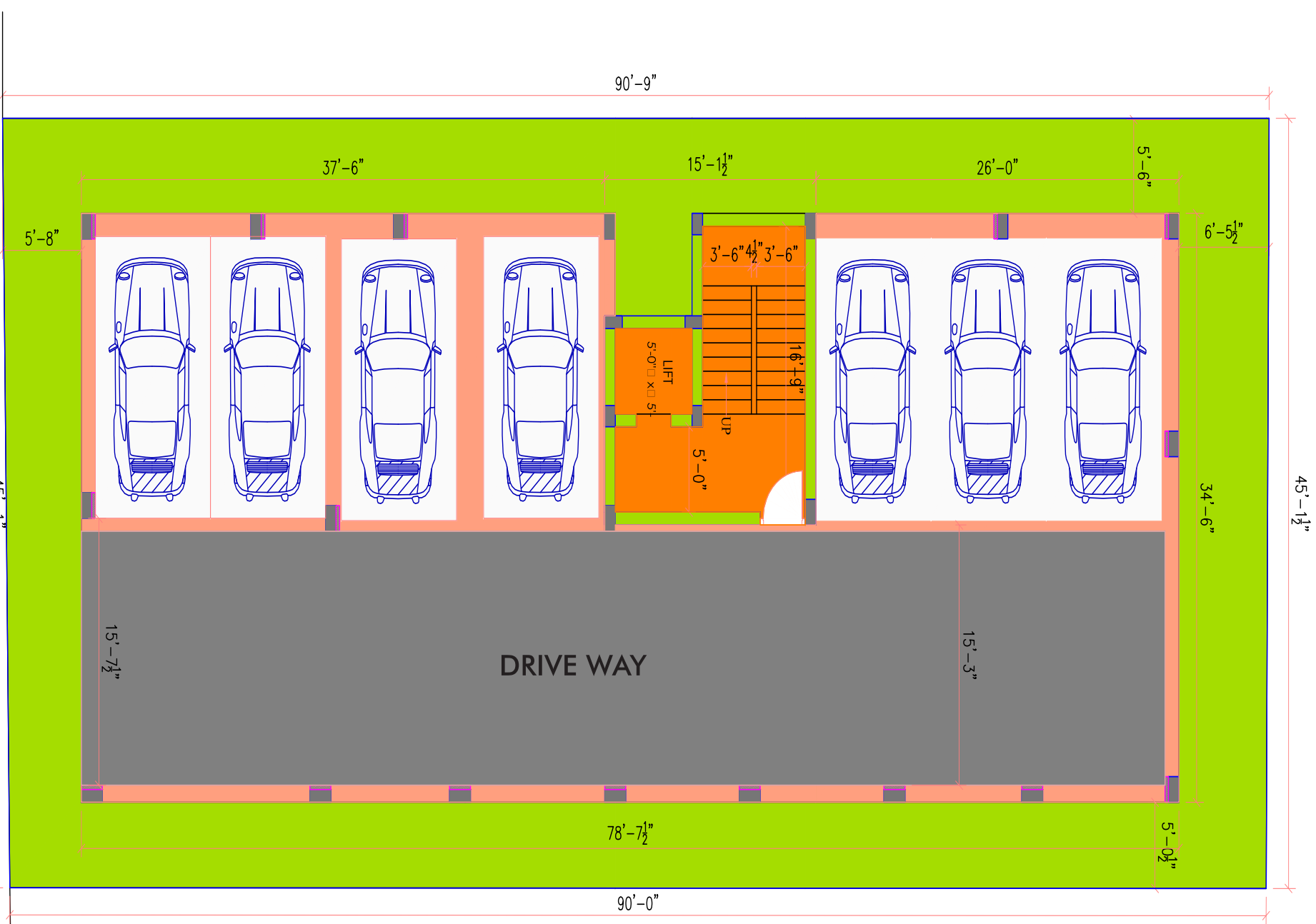

STILT FLOOR PLAN

20' WIDE RO

